

# LT-Series Precision Module

## DESCRIPTION

Precisely adjusted dot laser for alignment tasks. The LT transmitter can be obtained as a standard component in the laser colors red and green. The laser module is reverse voltage protected, potential-free, and can be operated without safety eyewear up to 1 mW. The laser beam is dot-shaped (not elliptical) and deviates after a distance of 20 m by less than 1 mm from the axis of the housing. High output power and/or a modulation option via a third wire are available as well.



## CHARACTERISTICS

- Laser beam and housing axis along the same line
- Circular beam profile
- Reverse voltage protection
- No safety eyewear required (up to 1 mW)
- h6 fit

## APPLICATIONS

- Alignment of machines
- Straightness test of crabs and carriages
- Concentricity test of rotating parts
- Aiming beam for marking tasks
- Controlling photodiodes / PSDs

## ACCESSORIES

Battery pack incl. charger

- Operating time with 635 / 650 nm, 1 mW Precision Module ca. 40 hours



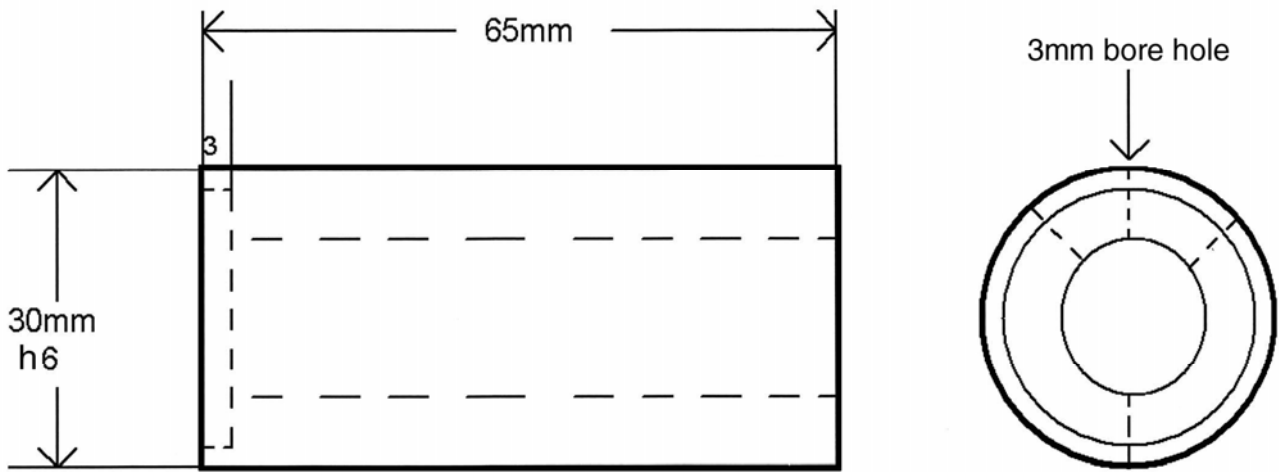

Product Name	LT-64/1AF-SD5	LT-65/1AF-SD5	LT-53/1AF-SD
Wavelength	635 nm (red)	650 nm (red)	532 nm (green)
Output power	1 mW	1 mW	1 mW
Beam profile	circular		
Beam divergence	~ 0,2 mrad	~ 0,2 mrad	~ 1,0 mrad
Warm up time	ca. 10 min		
Beam pointing error	less than 1 mm at a distance of 20 m		
Voltage	4,5 – 6 VDC	4,5 – 6 VDC	4,5 – 30 VDC
Current consumption	ca. 50 mA	ca. 50 mA	ca. 200 mA
Operating temperature	-10 °C to +50 °C	-10 °C to +50 °C	+15 °C to 35 °C
Housing	Aluminum, potential free, black anodized		
Dimensions	see drawing		
Options	Higher output power upon request Laser adjustment / modulation via third wire. Battery pack (incl. charger)		

Technical data subject to change.

