

FIBER-OPTIC FEEDTHROUGHS

KEY FEATURES

- From vacuum to 30 bars
- 10^{-5} mbar.l/s hermeticity
- ST/PC, ST/APC or SMA adapters

APPLICATIONS

- Vacuum
- Pressure

QUALITY

- ISO 9001:2015

CONTACT

France: +33 (0)3 81 42 28 64
 Germany: +49 (0)81 42 28 64
 UK: +44 (0)1245 491 499
 Email: info@lasercomponents.com
www.lasercomponents.com

Vacuum and pressure screw-in adapter feedthrough for 10^{-5} mbar to 30 bars applications

The KTRAV-IP series is a hermetic adapter feedthrough for pressure applications up to 30 bars.

It can be seen as a simplified feedthrough that does not integrate any fiber inside the body. It allows to hermetically connect two optical fiber patch cords terminated with **SMA, ST/PC or ST/APC** connectors. **Both sides must remain connected to maintain seal integrity.**

Indeed, the SMA and ST coupling parts feature an integral self-sealing design that ensures a watertight, environmentally, and hermetically sealed fiber connection. Hence, the KTRAV-IP adapter, when connected to the fiber patch cord, can reach a **hermeticity of 10^{-5} mbar.l/s**. Besides, it can withstand a **pressure level of up to 30 bars**. As a result, the connected optical fiber is completely protected from the surrounding environment.

The panel hermeticity is obtained by a gasket in the flange while the inner hermeticity is obtained by a gasket on the connector ferrule.

This hermetic adapter is supplemented by specific **ruggedized SMA or ST connectors** and dust caps.

We also offer a variety of compatible patch cords separately. **The SMA version supports fiber patch cords from 200 μm to 1500 μm core diameters** terminated with in-house SMA connectors equipped with a Viton O-ring. **The ST versions are compatible with any patch cords up to 1000 μm** and terminated with standard ST connectors.

Please contact us to discuss your specific requirements.



Vacuum and pressure screw-in adapter feedthrough for 10⁻⁵ mbar to 30 bars applications

FIBER-OPTIC FEEDTHROUGHS

STANDARD PRODUCT SPECIFICATIONS

Parameters	Specifications		
Pressure*	from vacuum to 30 bars		
Hermeticity*	10 ⁻⁵ mbar.l/s		
Adapter interface	ST/APC	ST/PC	SMA with Viton O-ring
Housing material	stainless steel 316L	stainless steel 316L	stainless steel 303 L
Panel drilling diameter	8 x 9.8 mm ^{+0.13}	8 x 9.8 mm ^{+0.13}	7.1 mm ^{0/+0.3}
Panel thickness	2.54 mm min.; 5.71 mm max.	2.54 mm min.; 5.71 mm max.	3.28 mm min.; 6 mm max.
Insertion loss @850 nm	0.5 dB typ. on GI 50 µm	0.5 dB typ. on GI 50 µm	0.7 dB typ. on 200 µm fiber
Operating temperature range	-55°C to +85°C	-55°C to +85°C	-40°C to +85°C
Protection index	IP68 with associated product, according to EN 60529, IEC 529 & DIN 40050		

*Valid only when connected!

MECHANICAL SCHEMES

ST/PC and ST/APC versions



SMA version



Mounting diagram for ST versions

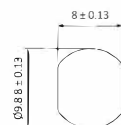

Mounting diagram for SMA versions

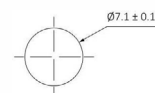

ORDERING INFORMATION

KTRAV - - - IP

connector type

ST : ST/PC

STA : ST/APC

SMA : SMA 905

Example : KTRAV-ST-IP
(Bulkhead hermetic adapter terminated with ST/PC connectors)

Order now

As part of its policy of continuous product improvement, SEDI-ATI Fibres Optiques reserves the right to change specifications at any time, without notification.