

## Data sheet Col\_HM-001-I

Optical properties	Value
<b>Wavelength</b>	1064 nm
<b>Incident beam size</b>	<3 mm*
<b>Incident beam mode</b>	MultiMode or Single Mode**
<b>Glass material: DOE/Lens</b>	Fused Silica/ BK7
<b>Collimation length</b>	> 200 mm
<b>Output Shape</b>	Square
<b>Output Size</b>	13.2x13.2 mm
<b>Coating</b>	AR/ AR ( specific type of coating)
<b>Optomechanical properties</b>	
<b>Module length</b>	92.7 mm
<b>External Diameter</b>	30.5 mm

\*Smaller beam has better effect on collimation length and shape contrast

\*\* For highly coherent laser speckles will appear

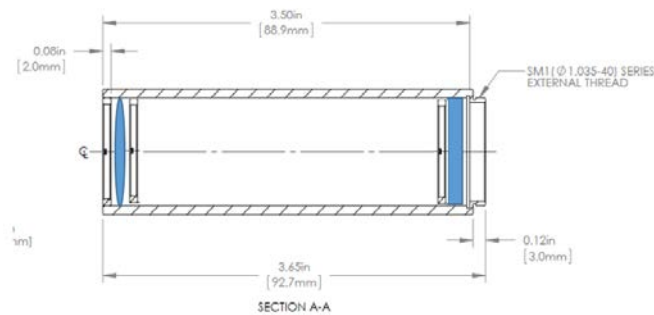

Copyright © 2017 Holo/Or LTD – Design and manufacture of diffractive optical elements  
This document is the sole and exclusive property of HOLO/OR LTD. Not to be distributed or divulged without prior written agreement